

NOTES (UNLESS OTHERWISE SPECIFIED)

- 1. LINAR SPECIFICATIONS:
ENC. RESOLUTION(+A/-A;+B/-B): 5,1 um
ENCODER REPEATABILITY: 10, 2 um
INDEX LOCATION(+Z/-Z): 1.5 - 3.5 mm R.H.S
- 2. MAGNET POLE PITCH: 18.3 mm
- 3. OPERATING TEMPERATURE: 0°C TO 40°C
- 4. PLATING: CERAKOTE, COLOR BLACK

Sold & Serviced By:

 Toll Free Phone (877) SERV098
www.electromate.com
sales@electromate.com

REVISIONS				
REV	ECR	DESCRIPTION	DATE	APPROVED

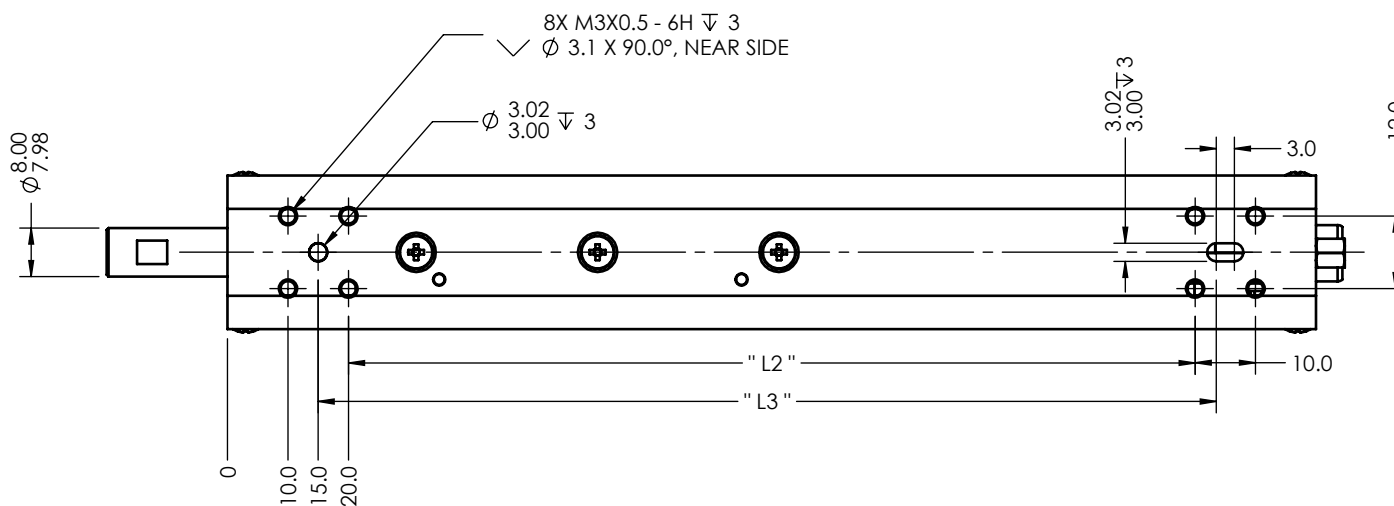
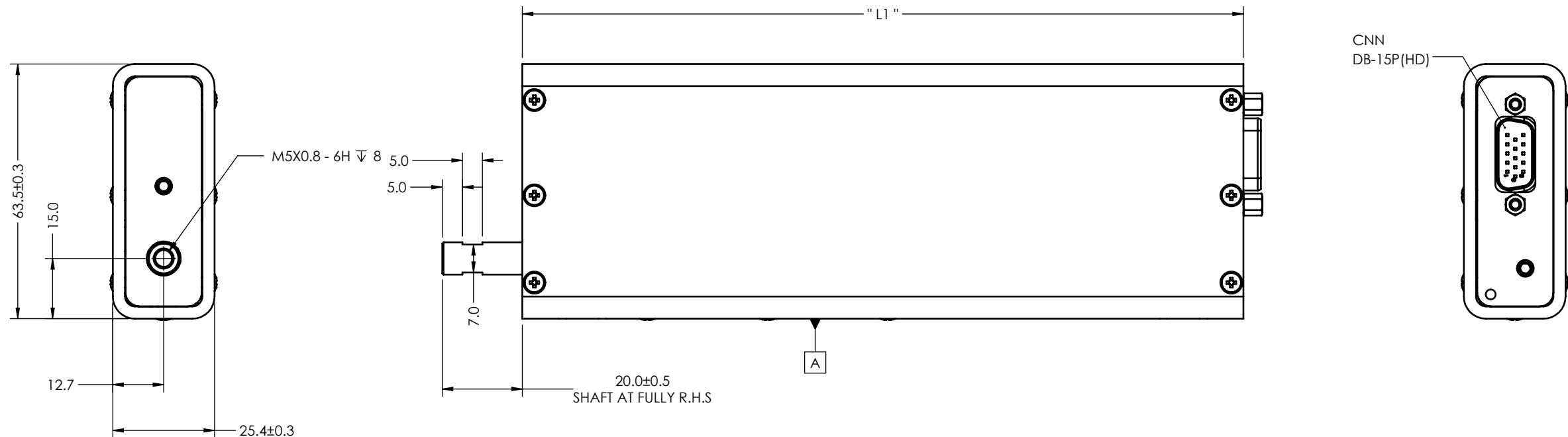

PIN	DETAIL
1	A+
2	B+
3	Z+
4	NC
5	MOTOR (U)
6	A-
7	B-
8	Z-
9	NC
10	MOTOR (V)
11	+5 VDC
12	5V RTN
13	NC
14	NC
15	MOTOR (W)

VACCUM ** (FACTORY CHECK)

No	DETAILS	UNIT	LDL25-025-3X-6	LDL25-050-3X-6	LDL25-075-3X-6	LDL25-100-3X-6
1	Linear stroke	mm	25	50	75	100
2	Peak force	N	23	23	23	23
3	Force constant	N/A	24	24	24	24
4	Peak current	A	0.95	0.95	0.95	0.95
5	Terminal resistance	Ohm	51	51	51	51
6	Coil inductance	mH	3.19	3.19	3.19	3.19
7	Moving mass	Kg	0.1	0.11	0.12	0.13
8	Total mass	Kg	0.9	1.1	1.3	1.6
9	Vacuum option		YES(**)	YES(**)	YES(**)	YES(**)
10	Spring return opt		YES	YES	YES	YES
11	Dimension L1	mm	155	180	217	255
12	Dimension L2	mm	115	140	177	215
13	Dimension L3	mm	123.5	148.5	185.5	223.5

- CONNECTOR OPTION:
1. D-SUB(HD MALE): 15
 2. PIGTAIL CABLE (0.5 METER LG)
 3. FLYING LEAD CABLE (3 METER LG)
 4. M12 DIN CONNECTOR (CONSULT FACTORY)

REF. NUMBER	LDL25
CONTRACT	LDL25-050

UNLESS OTHERWISE SPECIFIED
 ALL DIMENSIONS ARE IN MM
 BREAK EDGES AND REMOVE BURRS
 TOLERANCES
 X: ±0.5 X.X: ±0.1
 X.XX: ±0.03 ANGLE: ±0.1°
 CONCENTRICITY: ±0.025
 ROUNDNESS: ±0.025
 EDGE BREAKS: 0.2 MAX
 ALL DIMENSIONS AND TOLERANCES ARE FINAL

MATERIAL:	NAME	DATE
FINISH:	DWN BY	TV 12/18/20
MACHINE FINISH: 1.6	CHK BY	TV 12/18/20
INTERPRET PER: ASME Y14.5-2009	ENG APP	TV 12/18/20
THIRD ANGLE PROJECTION	MFG APP	
	QA APP	

SMAC 5807 VAN ALLEN WAY
CARLSBAD CA, 92008
(760) 929-7588

MOVING COIL ACTUATORS

TITLE: **LDL25-XXX-YY-6F**

SIZE: **B** PART NO: **LDL25-XXX-YY-6F** REV: **A1**

SCALE: 1:2 **DO NOT SCALE** SHEET: 1 / 1